

TITLEDUVA TITAT LAEINS JV

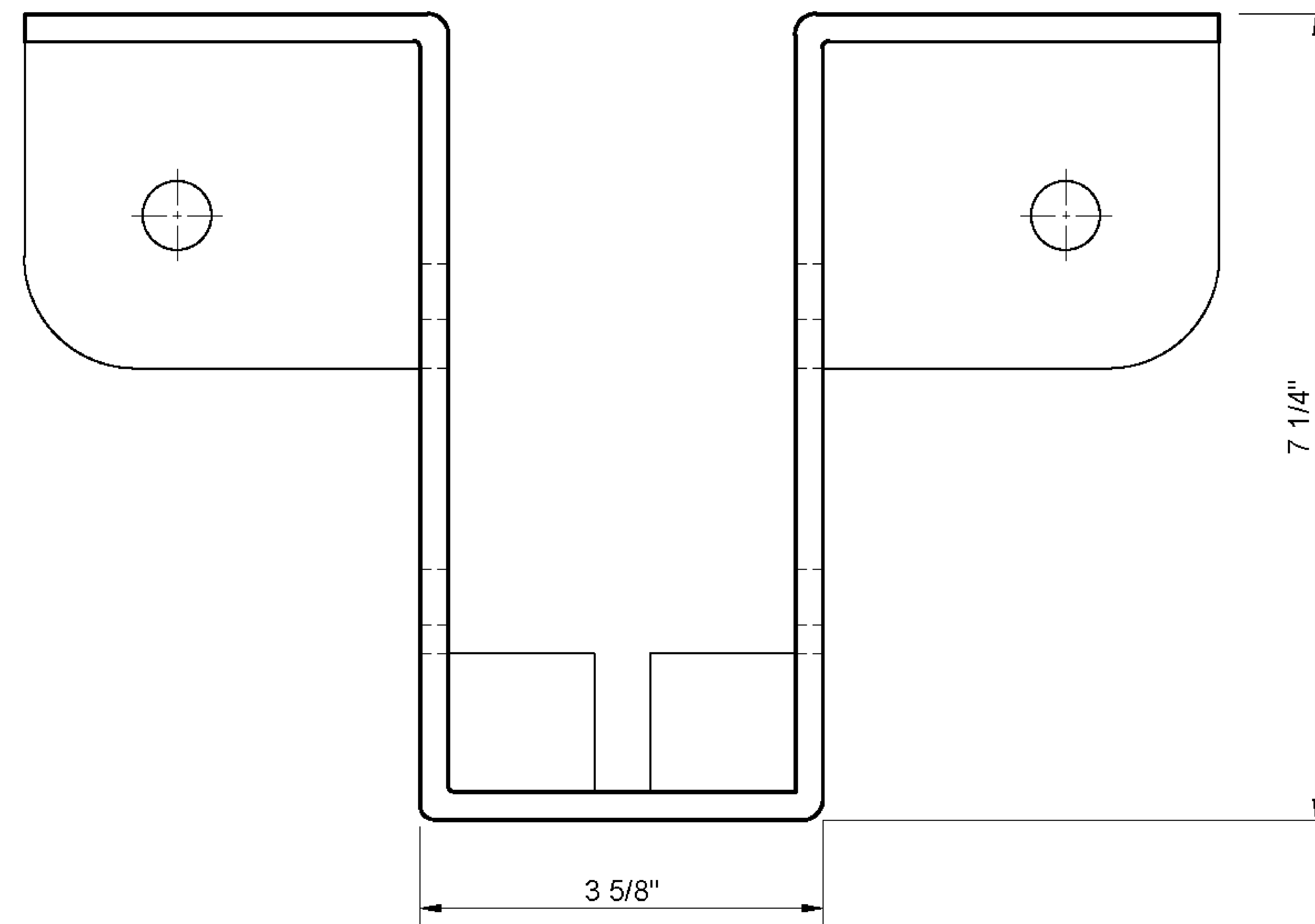

GENERAL NOTES:

- SUPPORT NP3 IDENTIFIED ON THIS PLAN IS SUITABLE FOR ANY USE ON CONSTRUCTION PROJECTS IN THE PROVINCE OF SASKATCHEWAN ACCEPTABILITY IS SUBJECT TO THE LIMITATIONS SET FORTH BELOW AS WELL AS THE MANUFACTURING PLAN FOR SUPPORT NP3, DATED FEBURARY 2020.
- THE MAXIMUM LOAD ON THE SUPPORT IS 3,000 LBS.
- FOLLOW ALL THE MANUFACTURER'S RECOMMENDATIONS FOR THE INSTALLATION OF ANCHORAGES INCLUDING, WITHOUT LIMITATION, (PUNCHING METHOD, HOLE CLEANING, TORQUE TO BE APPLIED TO THE BOLT DURING INSTALLATION, DISTANCES FROM RIVERS ETC.).
- ANCHORAGES MUST BE LESS THAN 8 INCHES FROM A CONCRETE SIDE AND / OR ANY OTHER DRILLING.
- BEFORE INSTALLATION, THE INSTALLER MUST VALIDATE THAT THE CONCRETE HAS A MINIMUM COMPRESSION RESISTANCE OF 15 MPA AND THAT THE CONCRETE IS IN GOOD CONDITION.
- CERTIFICATION APPLICABLE WITH HILTI HUS-HR 1/2 " x 4 " 1/2 ANCHORAGES WITH A MINIMUM OF 4 " 1/4 OF EMBEDMENT IN FULL CONCRETE.

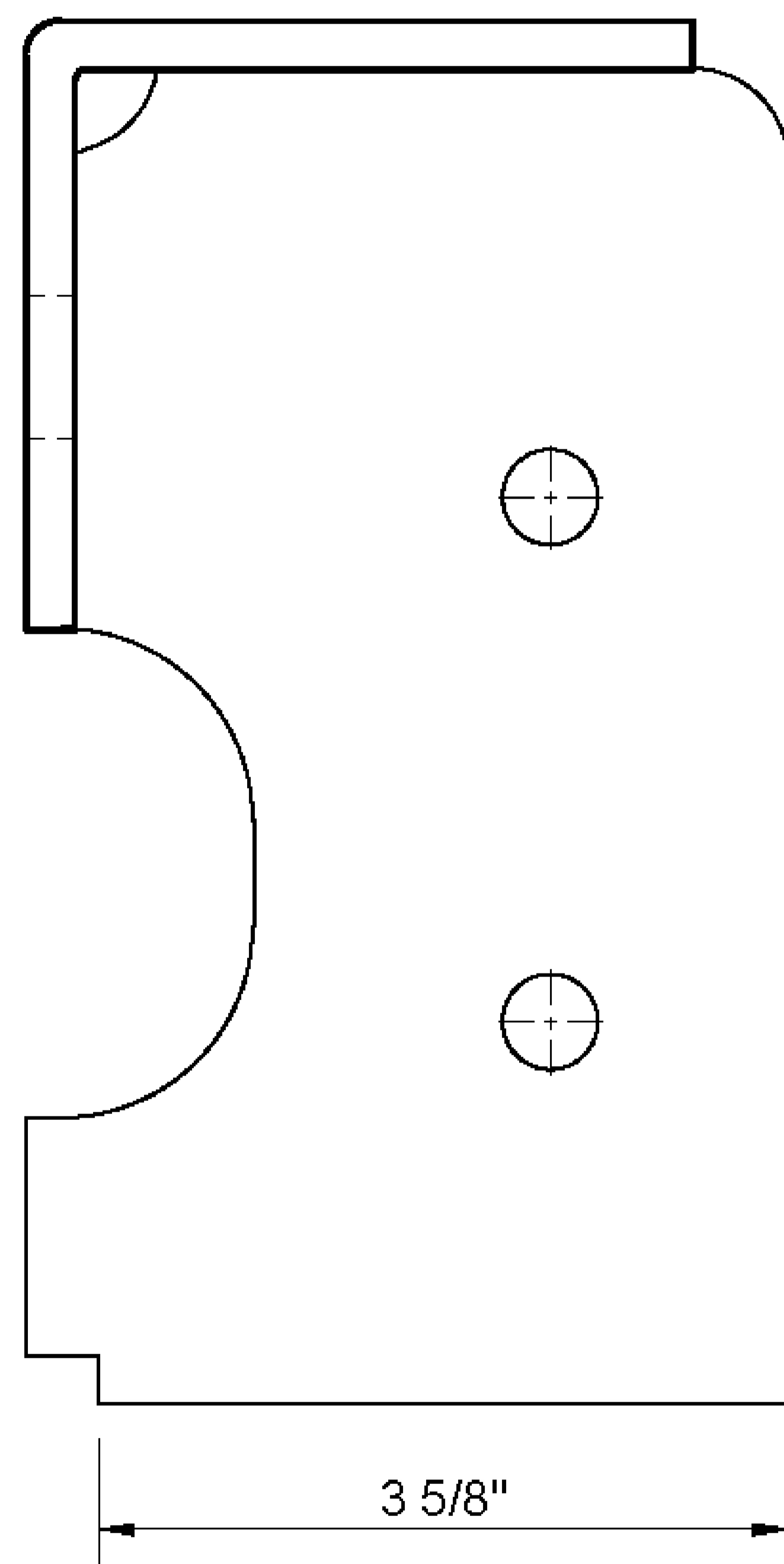
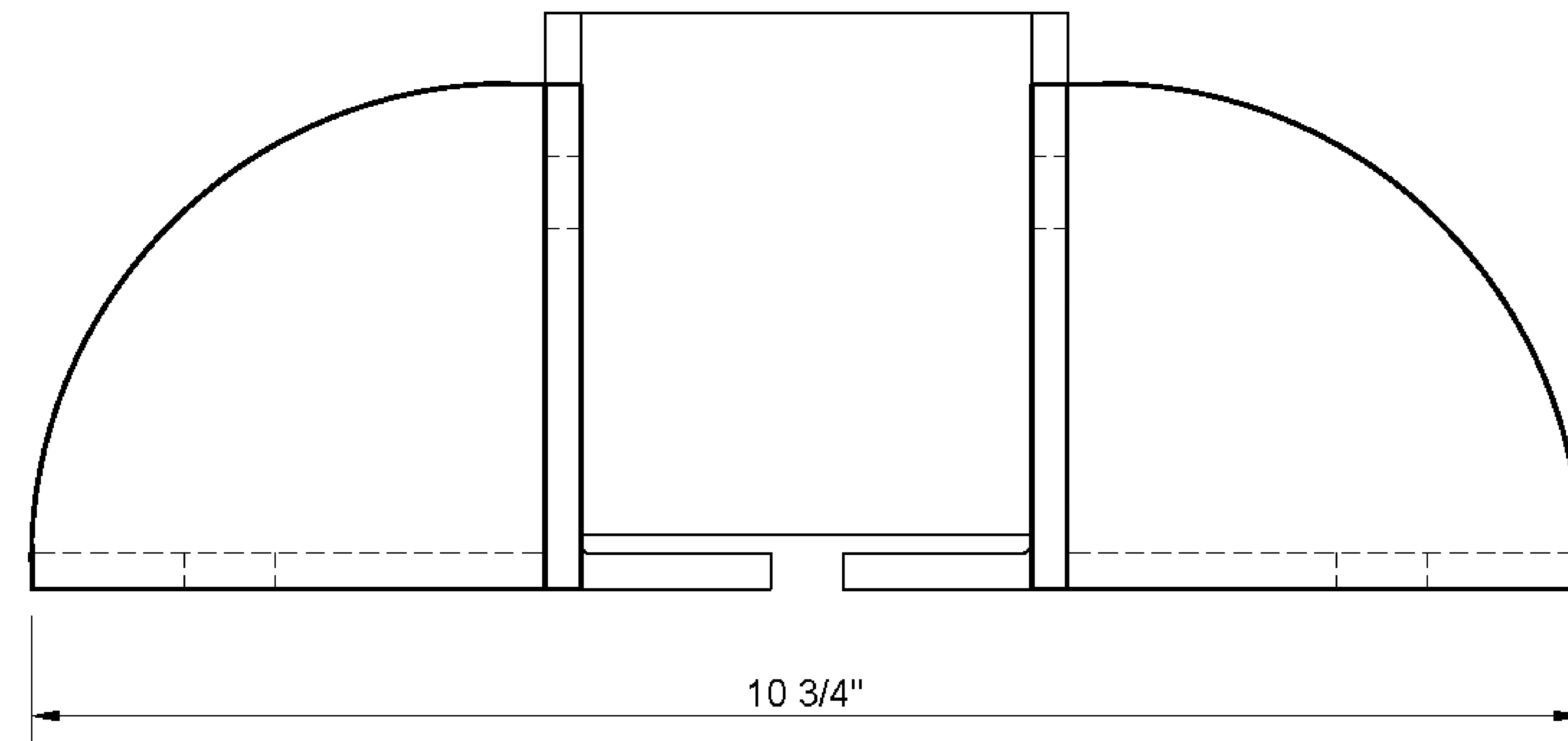

DESIGNED BY



NAMI FIXATIONS inc.
NP3 SUPPORT
INSTALLATION QUOTE

DRAFTER: A. FERREIRA	SCALE: 6" = 1'-0"
DESIGNER: P-L. SÉGUIN, ing.	DATE: 2020/03/04
P-L. SÉGUIN, ing.	PROJECT No: G004659
P-L. SÉGUIN, ing.	DRAWING No: ST-CR-02
SHEET No: 2 of 2	